

↓ Complete & Sign Here ↓
 Drawing Approved By _____

Company Name: _____	
Signature: _____	
Print Name: _____	Date: _____

(20 RU Rack Section)

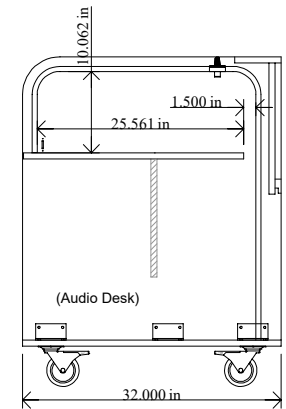
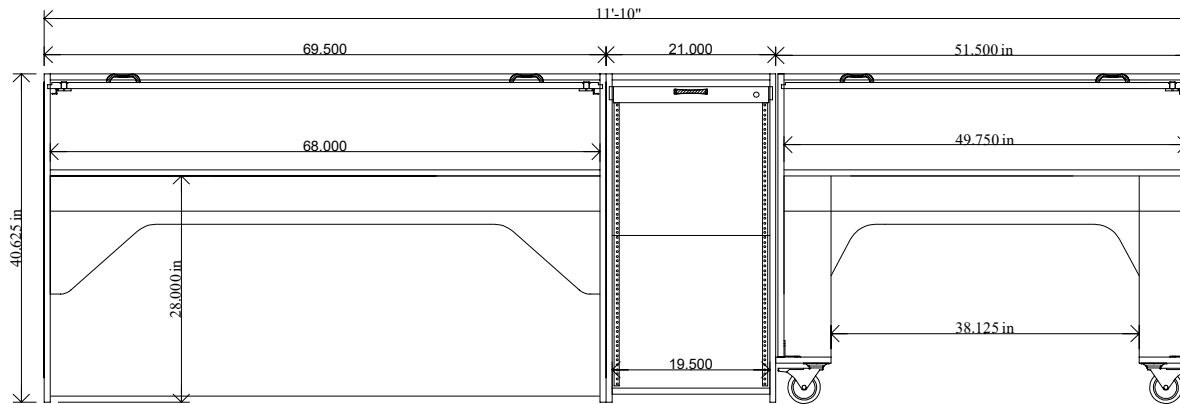
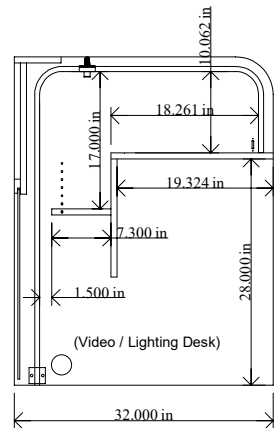
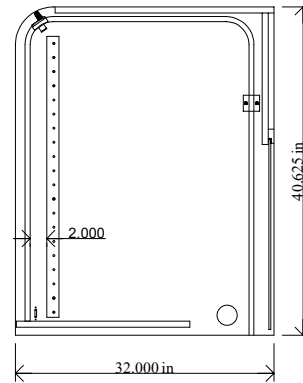

TEAK Finish



1717 East 6th St., Mishawaka, IN 46544
 PH (574) 255-6100 FX (574) 255-8131

CLIENT			
FILENAME			
REV DATE	04/03/24	AUTHOR	ADO
TOLERANCES 0.25" +/-			
SCALE	no scale	DWG NO	23070
NOTES			

Notice:
 The information in this document incorporates proprietary rights of HSA. Any party accepting this document does so in confidence and agrees that it shall not be duplicated in whole or in part, nor disclosed to others, without the express written consent of HSA. All drawings and quotations effective for 30 days from date of issue. Copyright 1995-2024 by HSA, Inc. All rights reserved.